

1.9335.T.00

Carrier Stainless Steel/PA Swing Lid

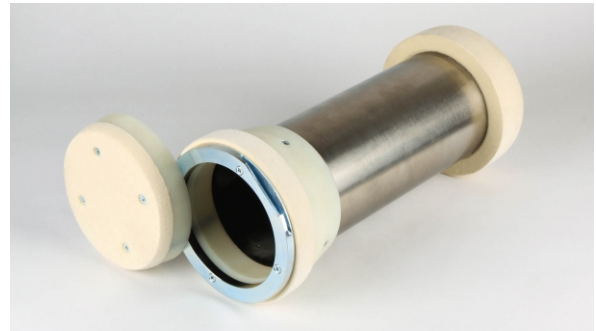

Carrier Stainless Steel/PA
swing lid for the transport of heavy parts

Loading capacity: A = 335 mm
B = 114 mm Ø
= 3.4 litre

With:

- High-grade felt-rings
- One swing lid with spring-tumbler and safe self-keep closed

For:

- Tube dimension Do160
- Bend radius r = 800 mm or bigger

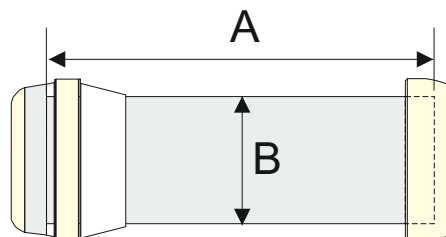

We reserve the right of changes!